

# *The Paisley*

The Highlands of Chelsea



*The Paisley*  
5 Bed – 4.5 Bath  
3869 SQFT

# The Paisley's Standard Features

## **Building Standards:**

- Slab on grade concrete foundation
- Traditional stick framing methods
- Framed "Green Corners" for higher energy
- Efficiency engineered AdvanTech Sub Floor
- Eco friendly Sentricon Termite Bait Station
- Studs, ceiling joists, and rafters will be 24" on center

## **Exterior Features:**

- Board and Batten & Hardie Lap siding exterior
- 30 Year Dimensional Architectural Roof Shingles
- Exposed rafter tails
- Double Hung, double paned, high efficiency, Low E glass, wood clad windows
- Fiberglass front door & locking system
- 8x8 smooth pine columns on the front & back porches
- 1x6 Cypress shutters with 1x4 raised Cypress accents
- \$15,000 Landscaping Allowance
- 3 Car garage

## **Interior Features:**

- 9' smooth ceilings throughout
- Open cell R20 Spray Foam insulation installed on roof deck
- Traditional R13 Batt/Fiberglass insulation in all exterior walls of heated space (draft stopping measures to seal insulation)
- Tankless gas water heater
- Gas furnace HVAC system
- Ventless gas log fireplace with brick surround and hearth and a shaker style mantel

## **Interior Finishes:**

### *Design Features*

- 6" Baseboards & cased windows throughout
- Recessed lighting throughout kitchen, living room, dining room & master bedroom
- Wire shelving installed in all closets, pantry & laundry areas
- Interior walls primed & painted with Sherwin Williams® Super Paint. Includes two wall colors, one trim color & one ceiling color

### *Flooring*

- Hardwood flooring will be installed in all first-floor common areas, powder bathroom, & laundry room.
- Ceramic tile in all full bathrooms
- Carpet in all other bedrooms, closets, upstairs common areas & any other rooms

### *Kitchen*

- Custom designed wooden cabinets in kitchen & bathrooms
- Granite countertops throughout
- Tile backsplash in kitchen
- Stainless Steel Appliances by Whirlpool®, including the dishwasher, gas range, wood vent hood & microwave
- Chrome Delta® Kitchen Fixtures
- Stainless Steel undermount sink in kitchen

### *Bathrooms*

- Tile shower with waterproofing system in the master bathroom
- Soaking Garden tub in master bathroom
- His & Hers vanities in master bathroom with under-mount sinks
- Chrome Delta® Bath Fixtures
- Vanity mirrors
- High quality fiberglass tub/ shower in all other bathrooms

### *Bedrooms*

- All Bedrooms will have ceiling fans

Customizing isn't complicated! Upgraded finish options are available for our standard finishes. We have all of our upgrade options, details, and pricing available for you in our Design Guide. View the link below to access it!

[www.hollandhomesllc.com/process/design-guide](http://www.hollandhomesllc.com/process/design-guide)

# MAIN LEVEL



# UPPER LEVEL

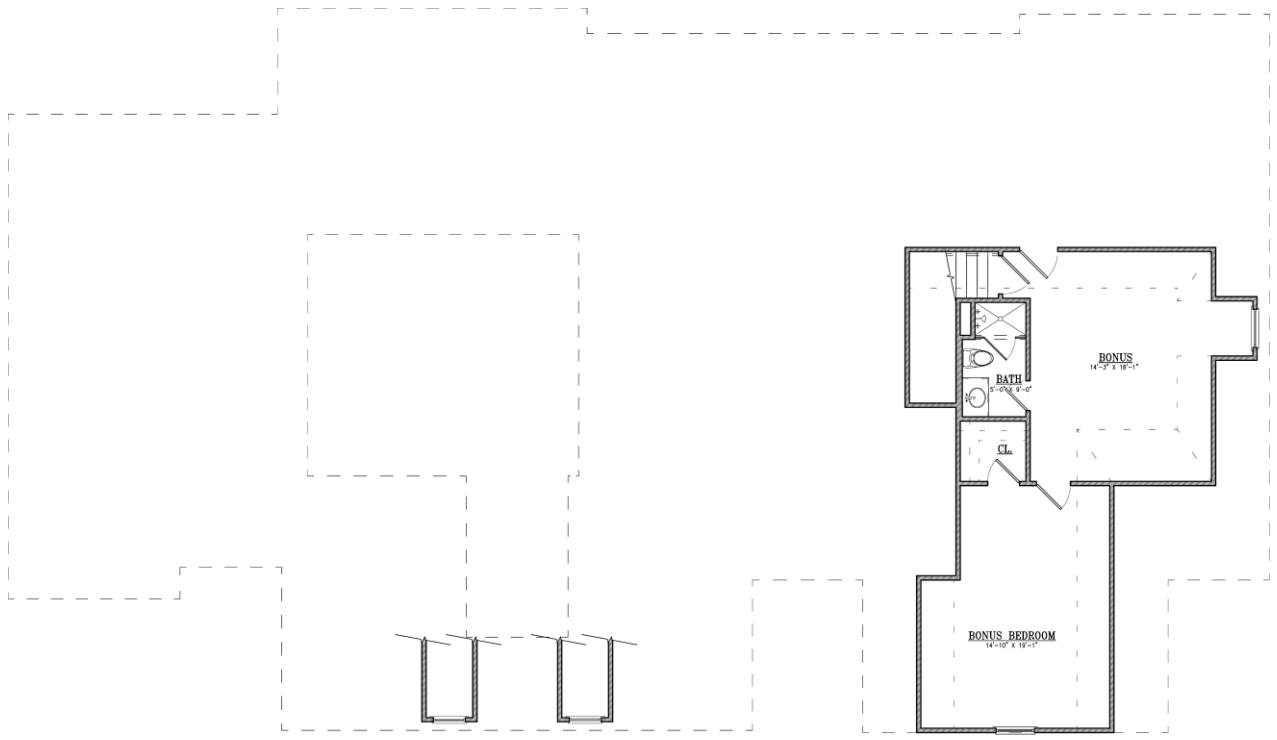



# THE HIGHLANDS *of Chelsea*



"Building Reputations"

[www.HollandHomesllc.com](http://www.HollandHomesllc.com)

**(334) 332-7157**

THE ELEVATION AND FLOOR PLANS CONTAINED HEREIN ARE NOT TO SCALE AND ARE GRAPHIC ILLUSTRATIONS FOR MARKETING AND PRESENTATION PURPOSES ONLY. ACTUAL FLOOR PLANS AND ALL MATERIALS MAY VARY PRIOR TO OR DURING CONSTRUCTION. SOME FEATURES SHOWN MAY BE OPTIONAL. HOLLAND HOMES RESERVES THE RIGHT TO SUBSTITUTE MATERIALS AND COMPONENTS OF SIMILAR QUALITY, AND TO CHANGE FEATURES, OPTIONS, AND ARCHITECTURAL DETAILS WITHOUT PRIOR NOTICE. ACCORDINGLY, NEITHER THESE MATERIALS, NOR ANY COMMUNICATION MADE OR GIVEN IN CONNECTION WITH THESE MATERIALS, MAY BE DEEMED TO CONSTITUTE ANY REPRESENTATION OF WARRANTY, CONTRACT OR GUARANTEE OR MAY OTHERWISE BE RELIED UPON BY ANY PERSON OR ENTITY UNLESS CONVEYED IN WRITTEN FORM. THIS MARKETING INFORMATION AND PLAN ARE PROPERTY OF HOLLAND HOMES.